

INDEX

LINE	St. No.		
MINNEAPOLIS JCT. TO COON CREEK	1M		
COON CREEK TO BOYLSTON	2		
BOYLSTON TO DULUTH	3		
BOYLSTON TO CASS LAKE	4		
		BROOKSTON TO KELLY LAKE	
BROOKSTON TO KELLY LAKE	6	Br. No. 66.7, Arlberg	6
		Br. No. 116.0, Kelly Lake	6
KELLY LAKE TO GUNN	8		
KELLY LAKE TO VIRGINIA	9		
ST. CLOUD TO BROOK PARK	11		
SAUK CENTRE TO CASS LAKE	12	KELLY LAKE TO GUNN	
ALLOUEZ TO SAUNDERS	13	Br. No. 9.5, Nashwauk	8
		Br. No. 9.6, Nashwauk	8
		Br. No. 12.6, Nashwauk	8
		Br. No. 15.2, Calumet	8
		Br. No. 17., Marble	8
STRUCTURES			
MINNEAPOLIS JCT. TO COON CREEK			
Br. No. 10.1 (Bdwy & Central Ave. NE)	1		
Br. No. 11.7 (Univ. Ave. NE at 29th Ave. NE)	1	Br. No. 24.7, Coleraine	8
Br. No. 12.4 (St Anthony Blvd.)	1	Br. No. 28.5, Gunn	8
Br. No. 12.5 (Soo Line Bridge)	1	M. A. Hanna Co., Flume Br., Moore	8
		KELLY LAKE TO VIRGINIA	
COON CREEK TO BOYLSTON		Br. No. 118.7, Kelly Lake	9
Signals at Brook Park	2	Br. No. 119.9, Hibbing	9
Br. No. 80.8, Brook Park	2	Br. No. 120.3 Hibbing	9
Br. No. 101.3, Stanchfield	2	Br. No. 120.5 Hibbing	9
Br. No. 109.3, Cambridge	2	Br. No. 122.0 Ruby Jct.	9
		Br. No. 123.6 Emmert Tower	9
BOYLSTON TO DULUTH		Br. No. 128.0 Buhl	9
6th Ave. Viaduct, Duluth (N.P.Ry)	3		
Br. No. 0.4, Duluth, (Footbridge)	3		
Garfield Ave. Ohd. Br. Duluth (N.P.Ry)	3		
Br. No. 2, Garfield Ave., Duluth.	3		
Drawbridge, Duluth, (N.P.Ry)	3		
Br. No. 3.5, Superior	3	ST. CLOUD TO BROOK PARK	
Br. No. 5.0, Superior	3	Br. No. 46.3, Mora	11
		Br. No. 54.2, Quamba	11
BOYLSTON TO CASS LAKE			
Br. No. 28.1, Carlton	4	SAUK CENTRE TO CASS LAKE	
Br. No. 35.3, Carlton	4	Br. No. 91.0, Park Rapids	12
Br. No. 41.0, Cloquet	4	Br. No. 118.8, Walker	12
Br. No. 55.4, Brookston	4	Br. No. 132.0, Wilkinson	12
		ALLOUEZ TO SAUNDERS	
		Br. No. 0.3, Saunders	13

GREAT NORTHERN RAILWAY
MESABI DIVISION
INDEX
FOR
CLEARANCE DIAGRAMS

OFFICE OF CHIEF ENGINEER, ST. PAUL, MINN.

CORRECTED TO *Jan. 1969*

DATE PRINTED

167-5956-A

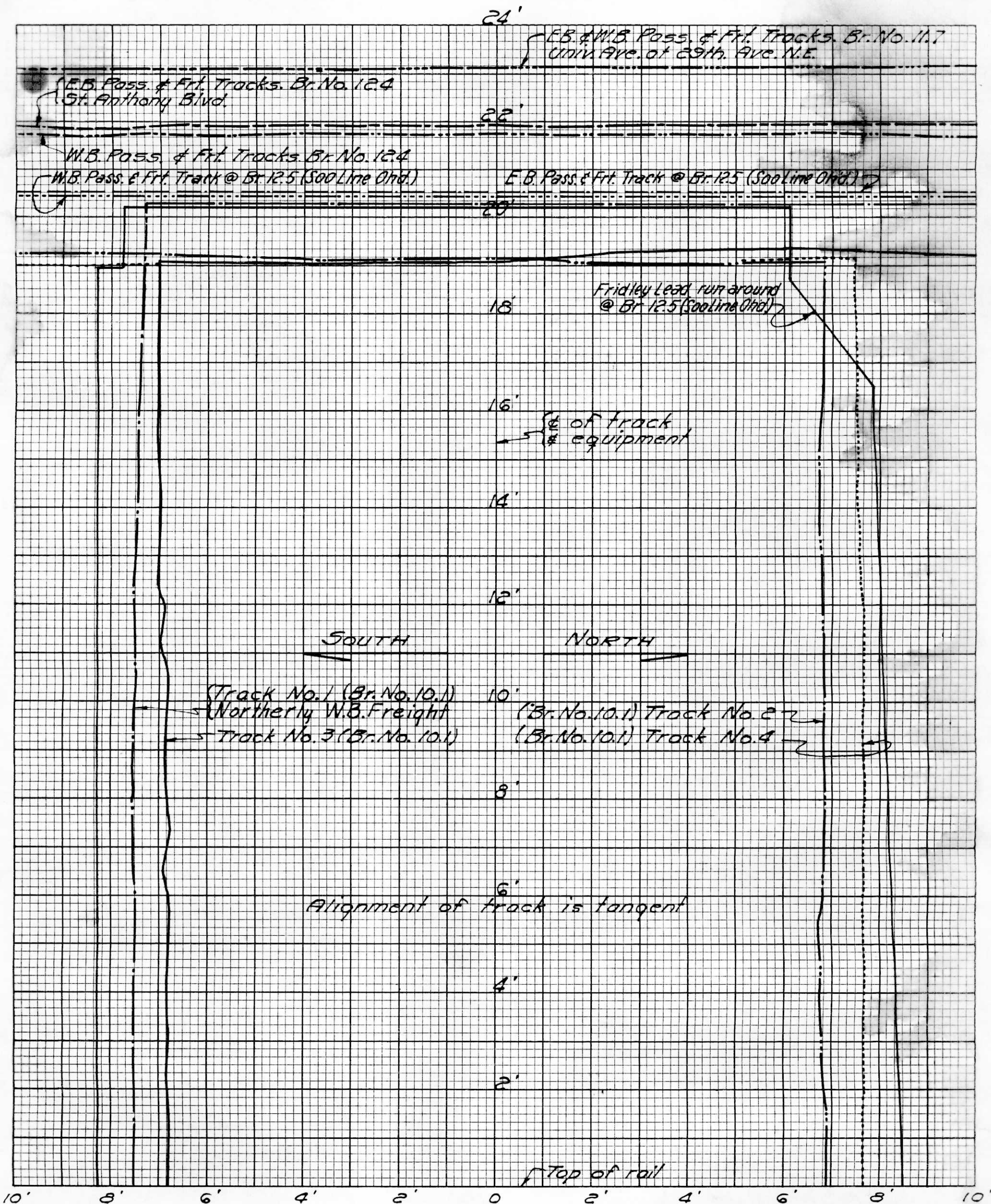

NOTE:
 File No 167-5956-1M refers to file number for the Mesabi Divn.
 File No 167-5958-10W refers to file number for the Willmar Divn.

GREAT NORTHERN RAILWAY
 MESABI & WILLMAR DIVISIONS
 MINNEAPOLIS JCT. TO COON CREEK JCT., MINN
BRIDGES NO. 10.1, 11.7, 12.4, & 12.5
 OHD. BRIDGES AT MPLS., MINN.
CLEARANCE DIAGRAM
 OFFICE OF CHIEF ENGINEER ST. PAUL, MINN.

CORRECTED TO *Jan. 1969*

DATE PRINTED

167-5956-1M
 167-5958-10W

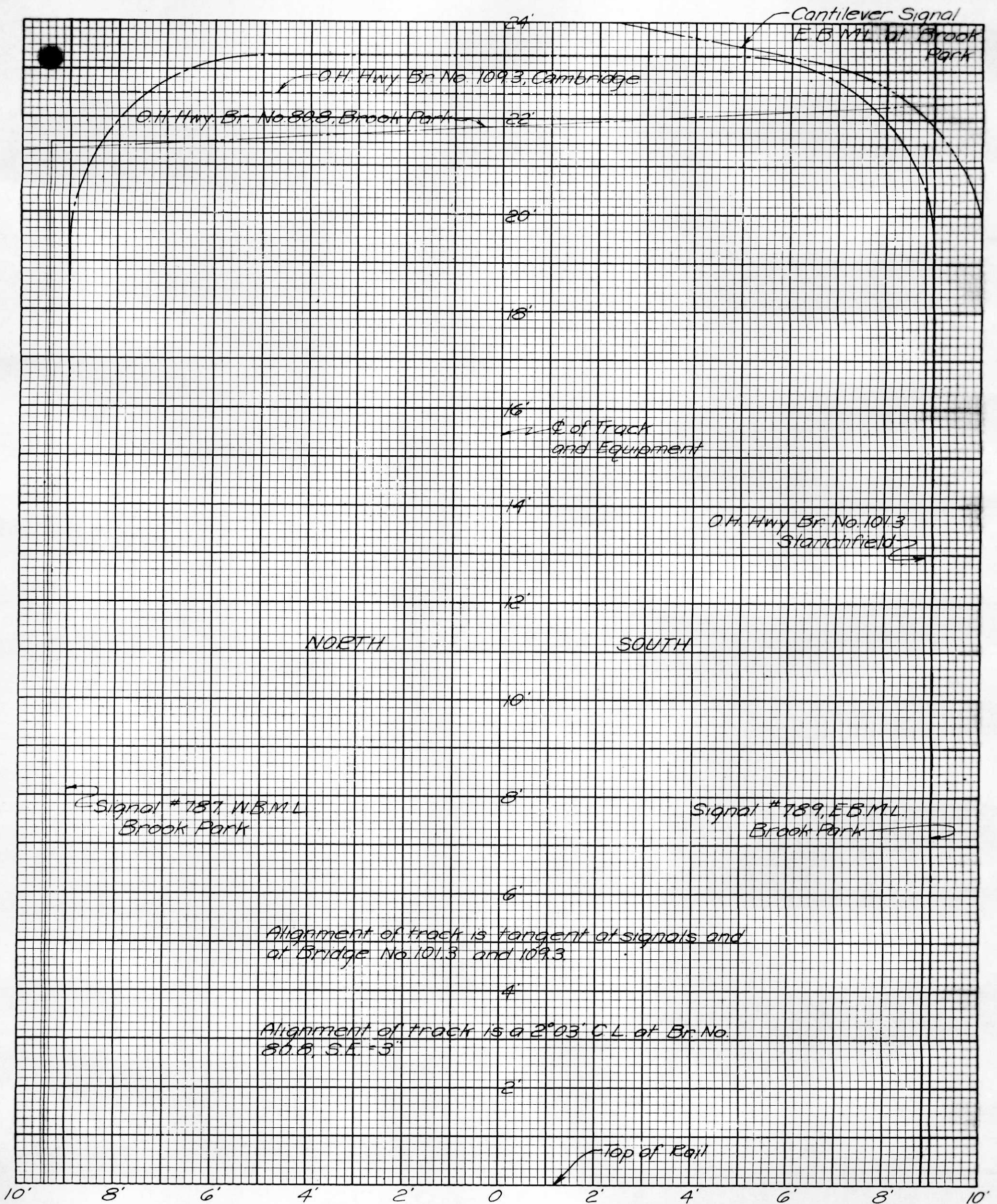

GREAT NORTHERN RAILWAY
MESABI DIVISION
**COON CREEK TO BOYLSTON
CLEARANCE DIAGRAM**

OFFICE OF CHIEF ENGINEER, ST. PAUL, MINN.

CORRECTED TO *July 1, 1952*

DATE PRINTED

167-5956-2

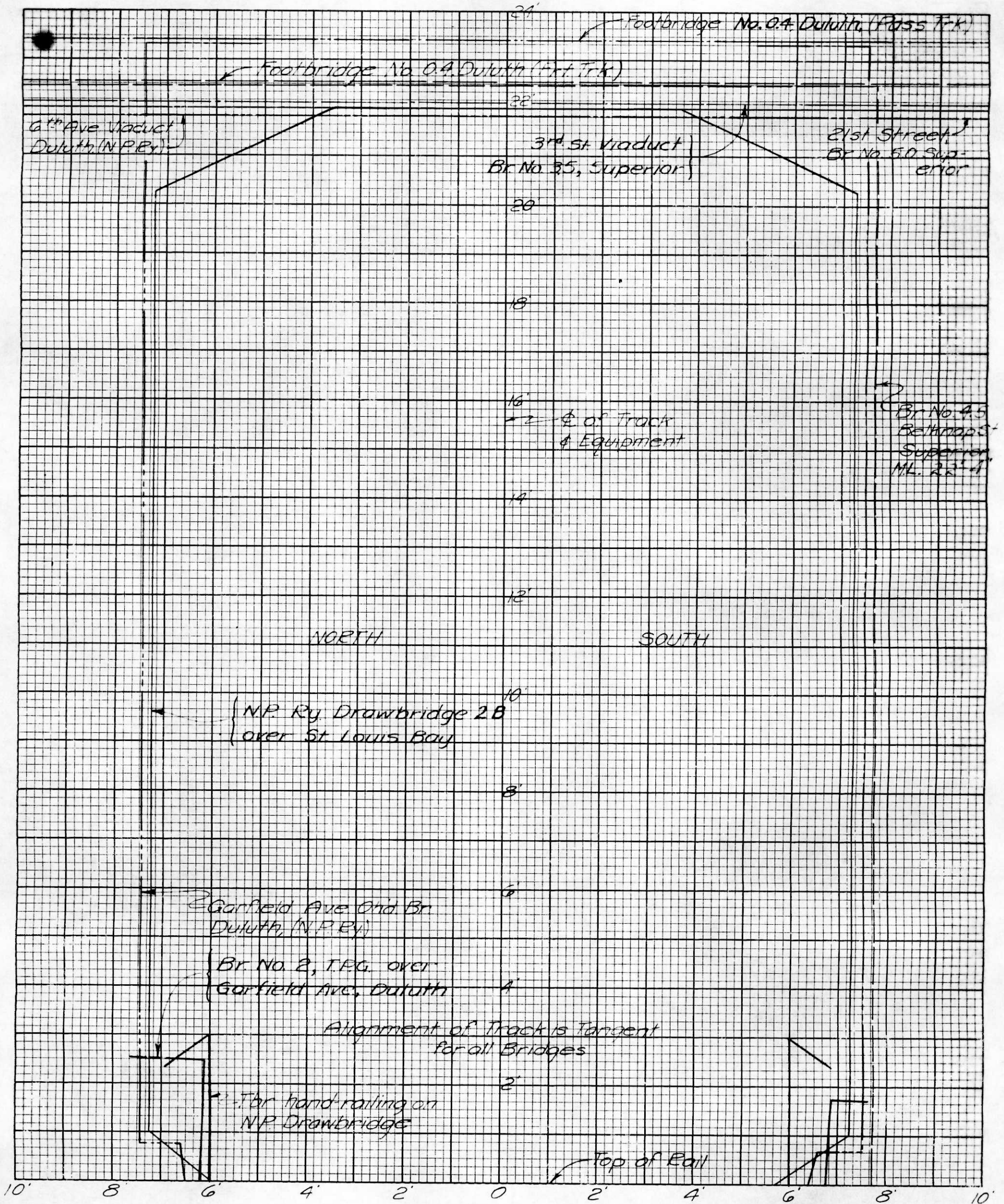

GREAT NORTHERN RAILWAY
MESABI DIVISION
**BOYLSTON TO DULUTH
CLEARANCE DIAGRAM**

OFFICE OF CHIEF ENGINEER, ST. PAUL, MINN.

CORRECTED TO *Nov. 1962*

DATE PRINTED

167-5956-3

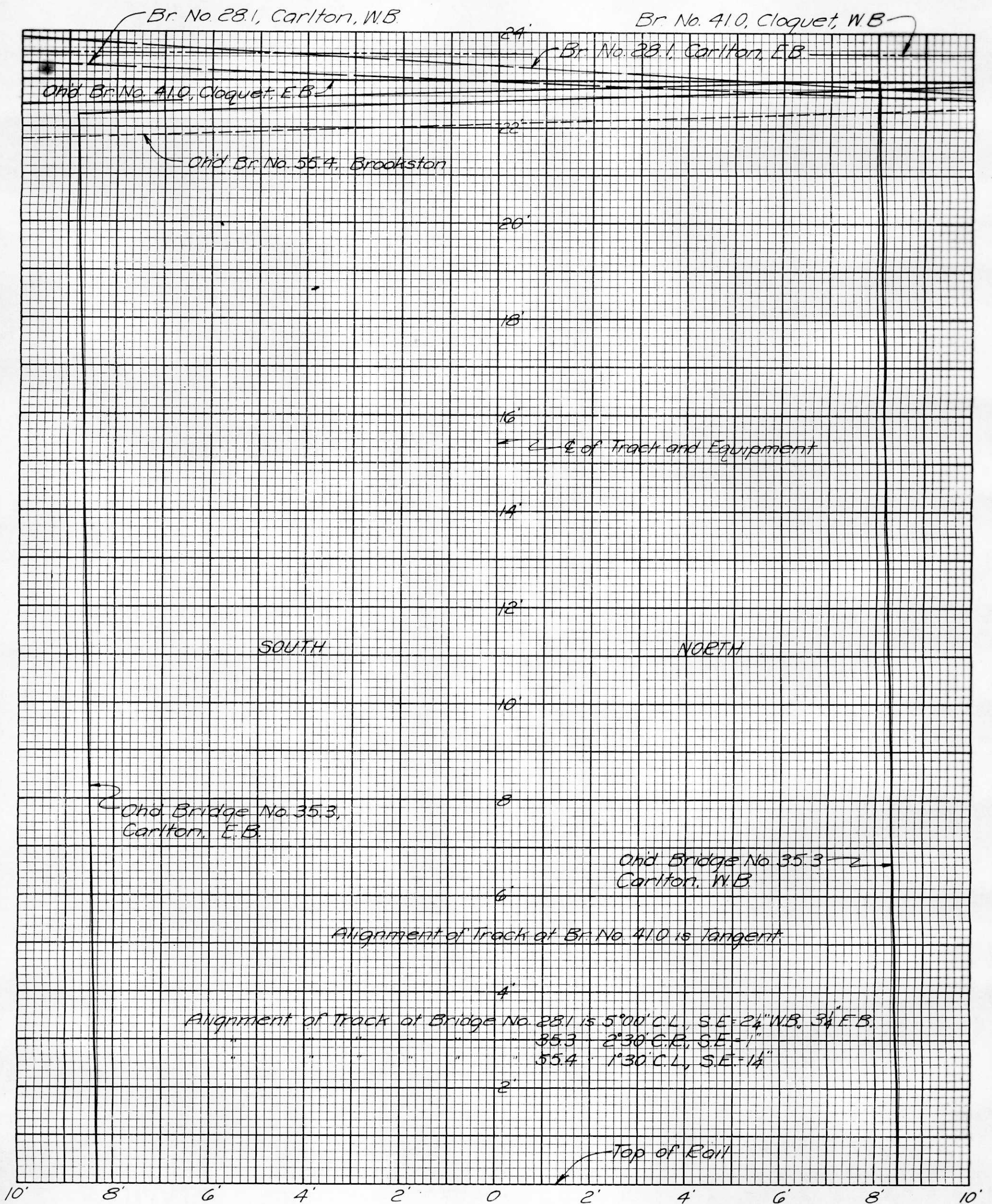

GREAT NORTHERN RAILWAY
MESABI DIVISION
BOYLSTON TO CASS LAKE
CLEARANCE DIAGRAM

OFFICE OF CHIEF ENGINEER, ST. PAUL, MINN.

CORRECTED TO *1/11/19*

DATE PRINTED

167-5956-4

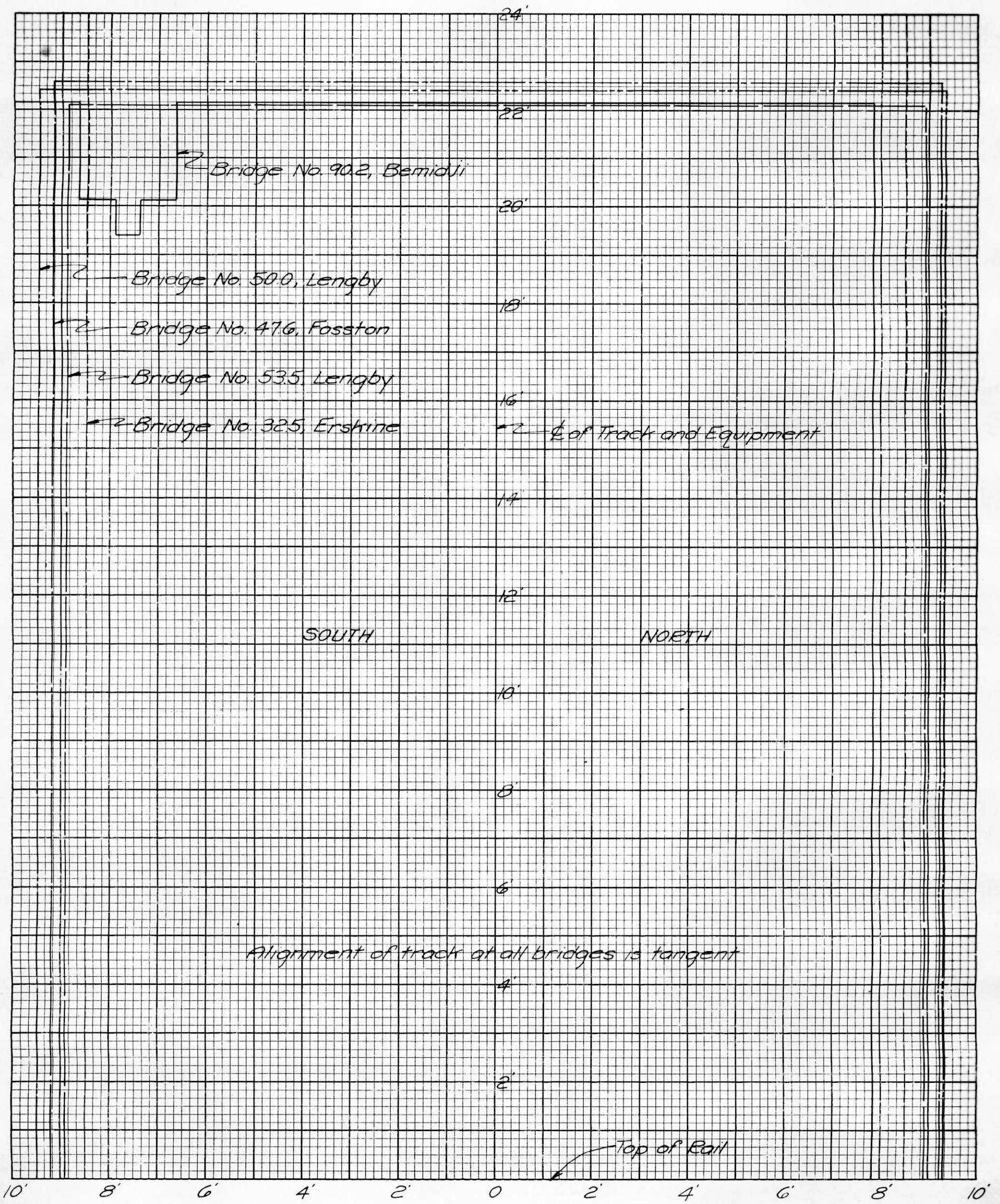

GREAT NORTHERN RAILWAY
 MESABI DIVISION
**CASS LAKE TO CROOKSTON JCT.
 CLEARANCE DIAGRAM**

OFFICE OF CHIEF ENGINEER, ST. PAUL, MINN.

CORRECTED TO *July 1, 1952*

DATE PRINTED

167-5956-5

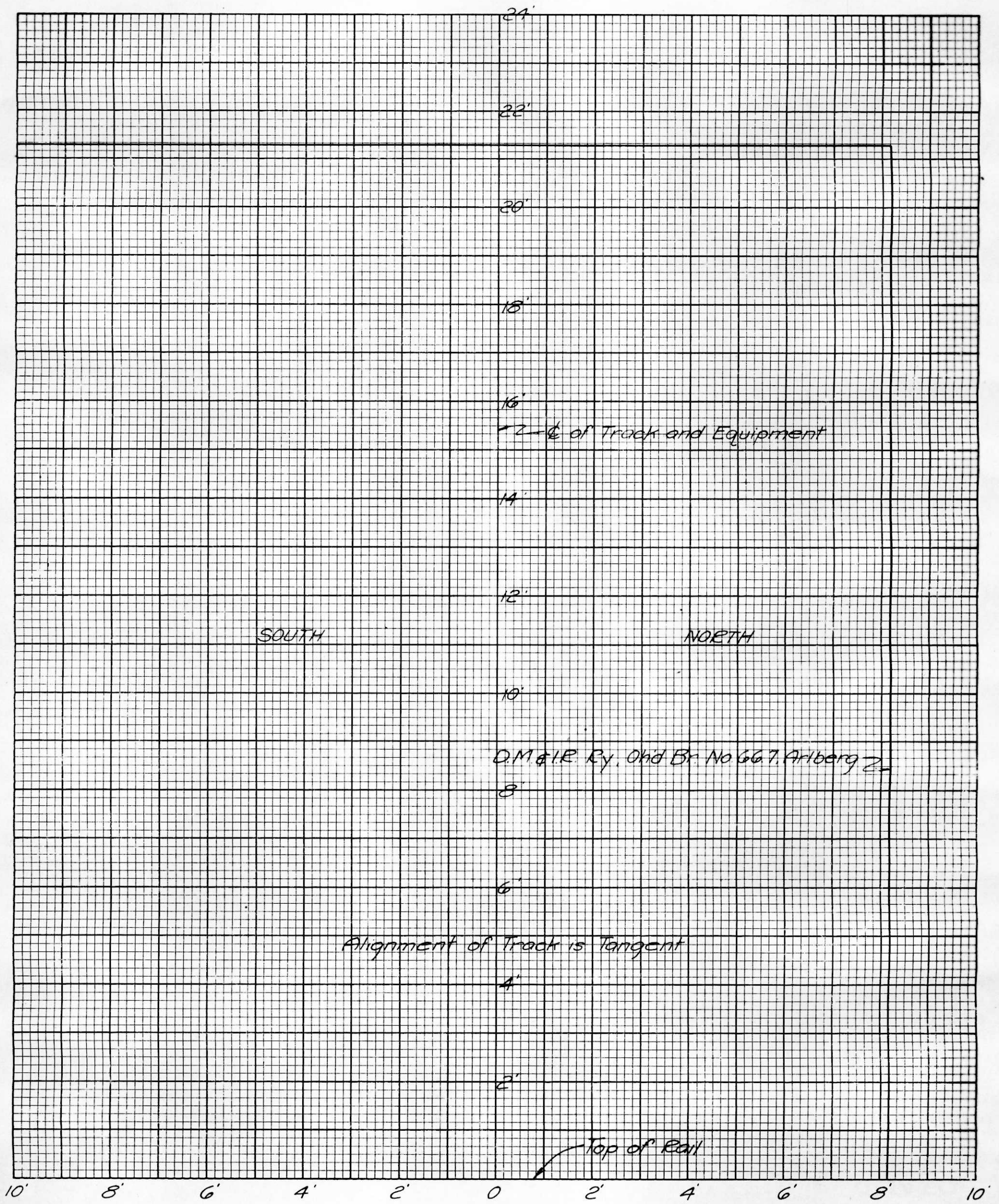

GREAT NORTHERN RAILWAY
 MESABI DIVISION
**BROOKSTON TO KELLY LAKE
 CLEARANCE DIAGRAM**

OFFICE OF CHIEF ENGINEER, ST. PAUL, MINN.

CORRECTED TO 1/11/1952

DATE PRINTED

167-5956-6

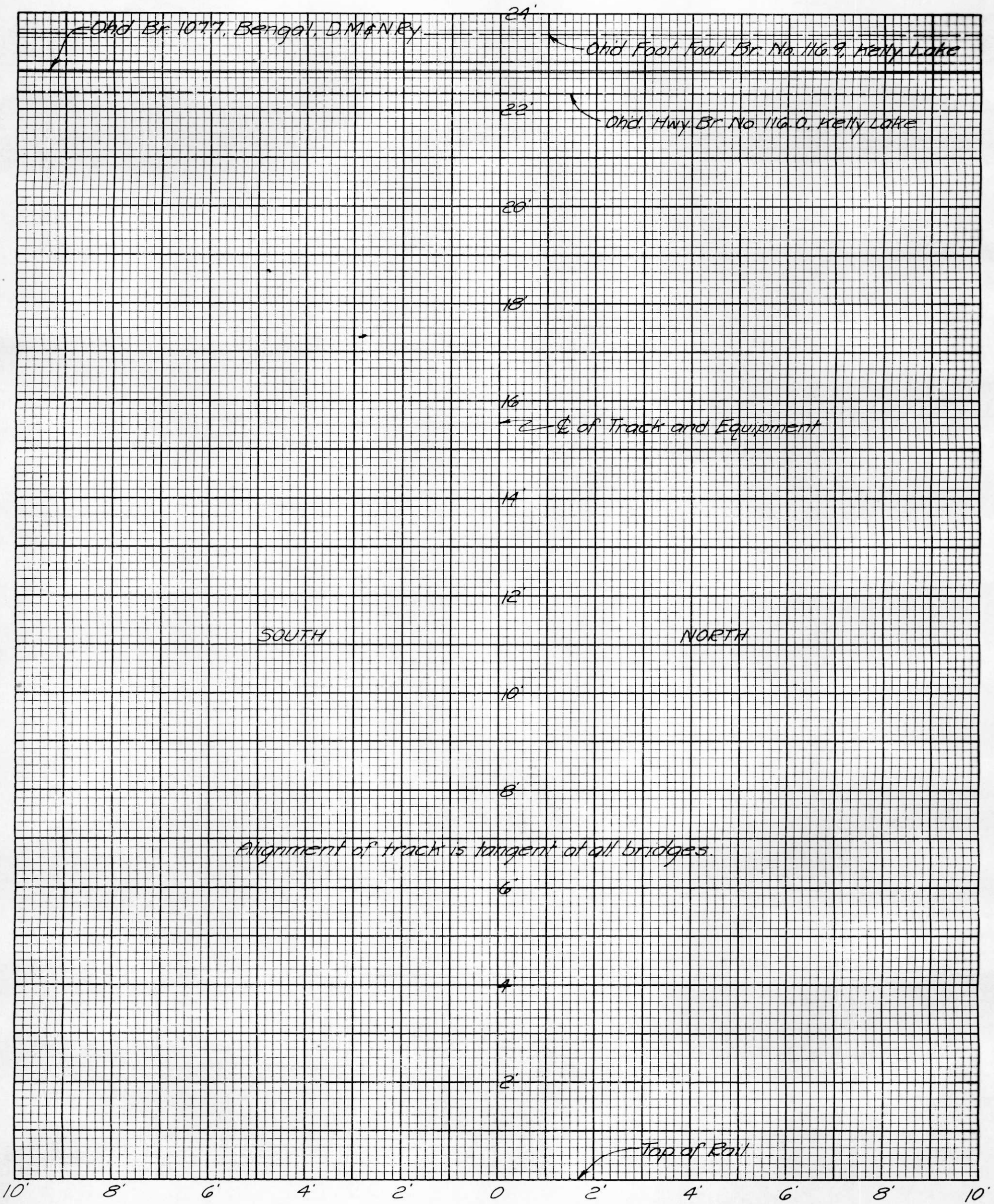

GREAT NORTHERN RAILWAY
 MESABI DIVISION
**KELLY LAKE TO SWAN RIVER
 CLEARANCE DIAGRAM**

OFFICE OF CHIEF ENGINEER, ST. PAUL, MINN.

CORRECTED TO July 1957

DATE PRINTED

167-5956-7

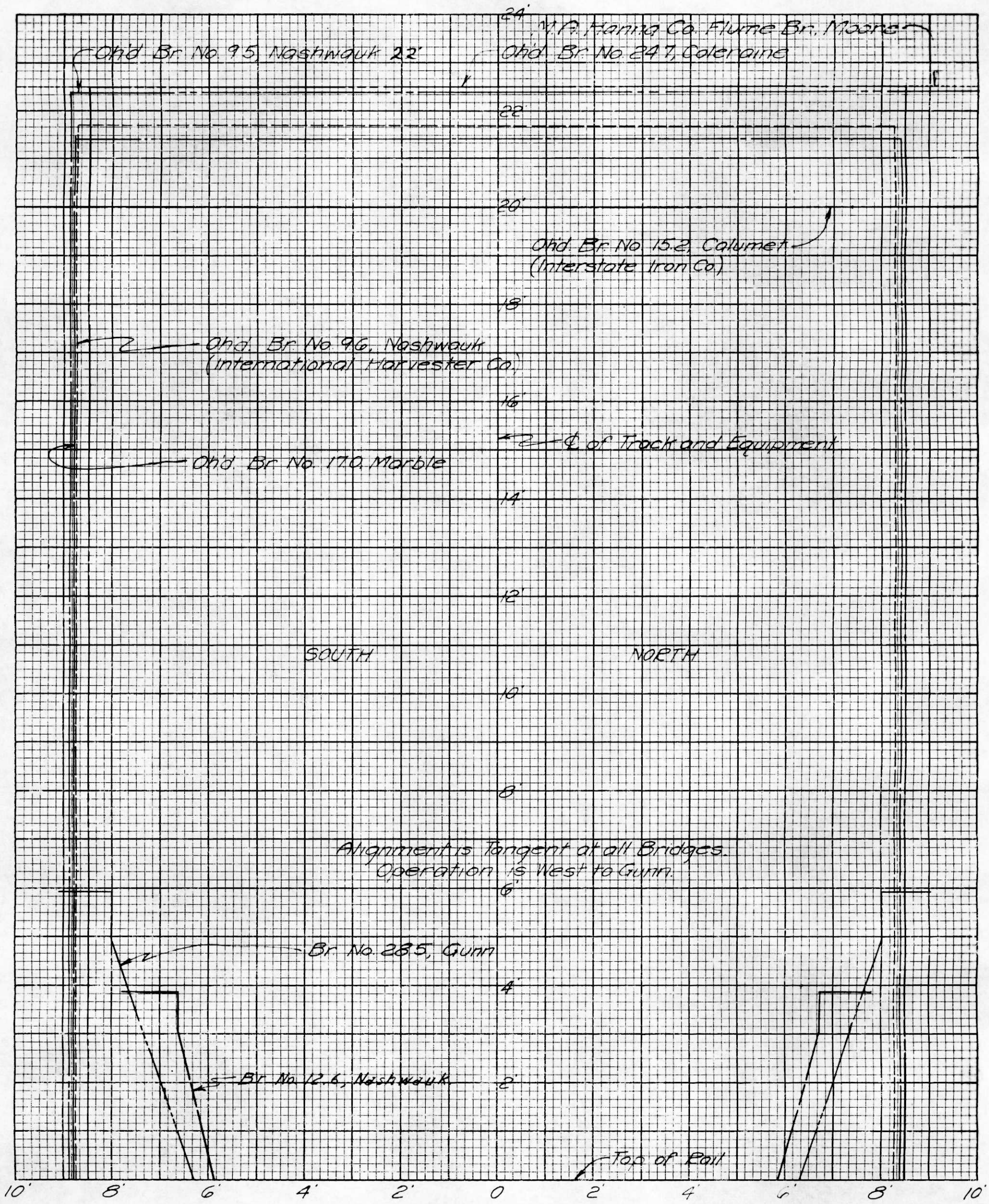

GREAT NORTHERN RAILWAY
 MESABI DIVISION
**KELLY LAKE TO GUNN
 CLEARANCE DIAGRAM**

OFFICE OF CHIEF ENGINEER, ST. PAUL, MINN.

CORRECTED TO Nov. 26.7

DATE PRINTED

167-5956-8

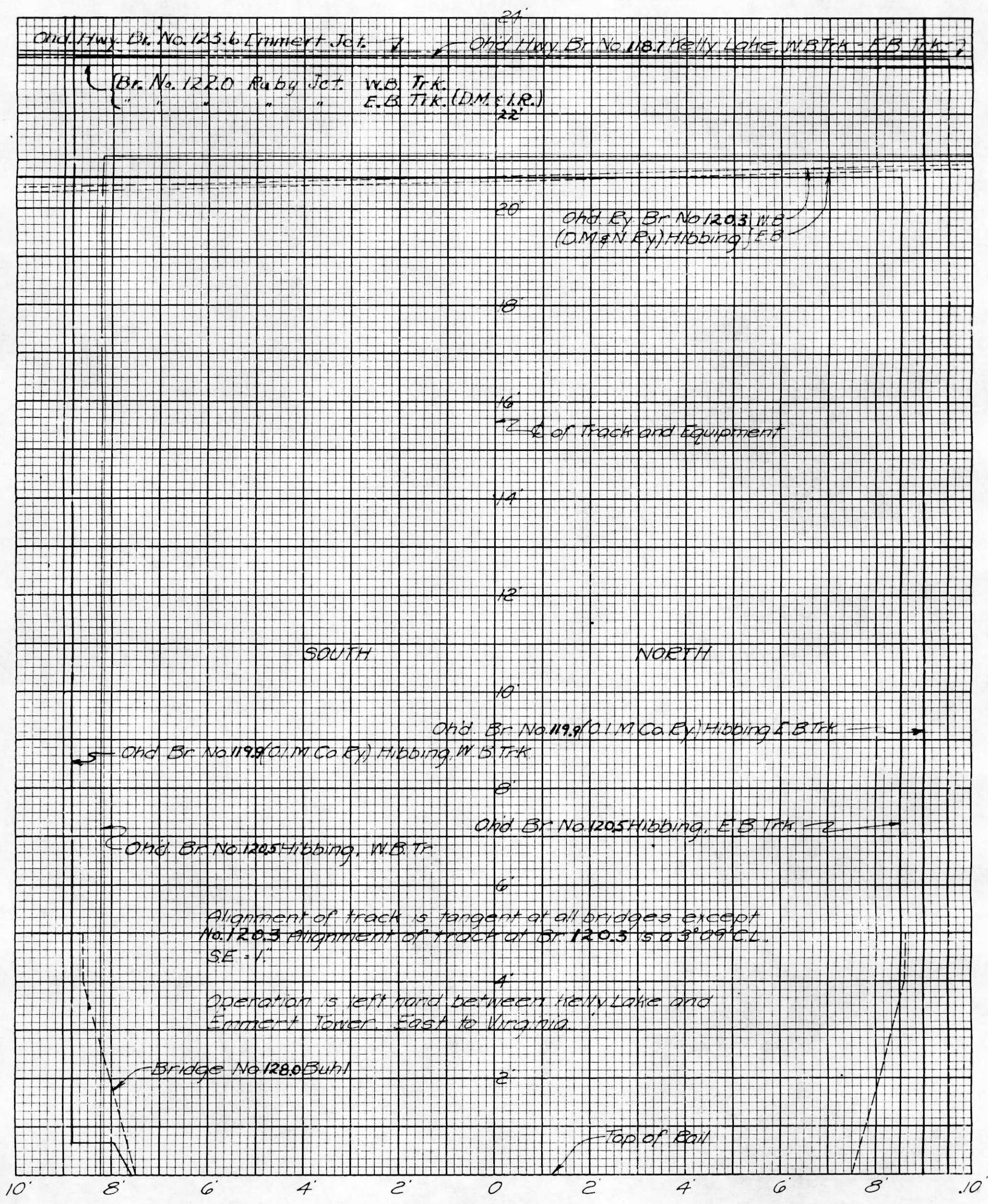

GREAT NORTHERN RAILWAY
 MESABI DIVISION
**KELLY LAKE TO VIRGINIA
 CLEARANCE DIAGRAM**

OFFICE OF CHIEF ENGINEER, ST. PAUL, MINN.

CORRECTED TO 1/21/1917

DATE PRINTED

167-5956-9

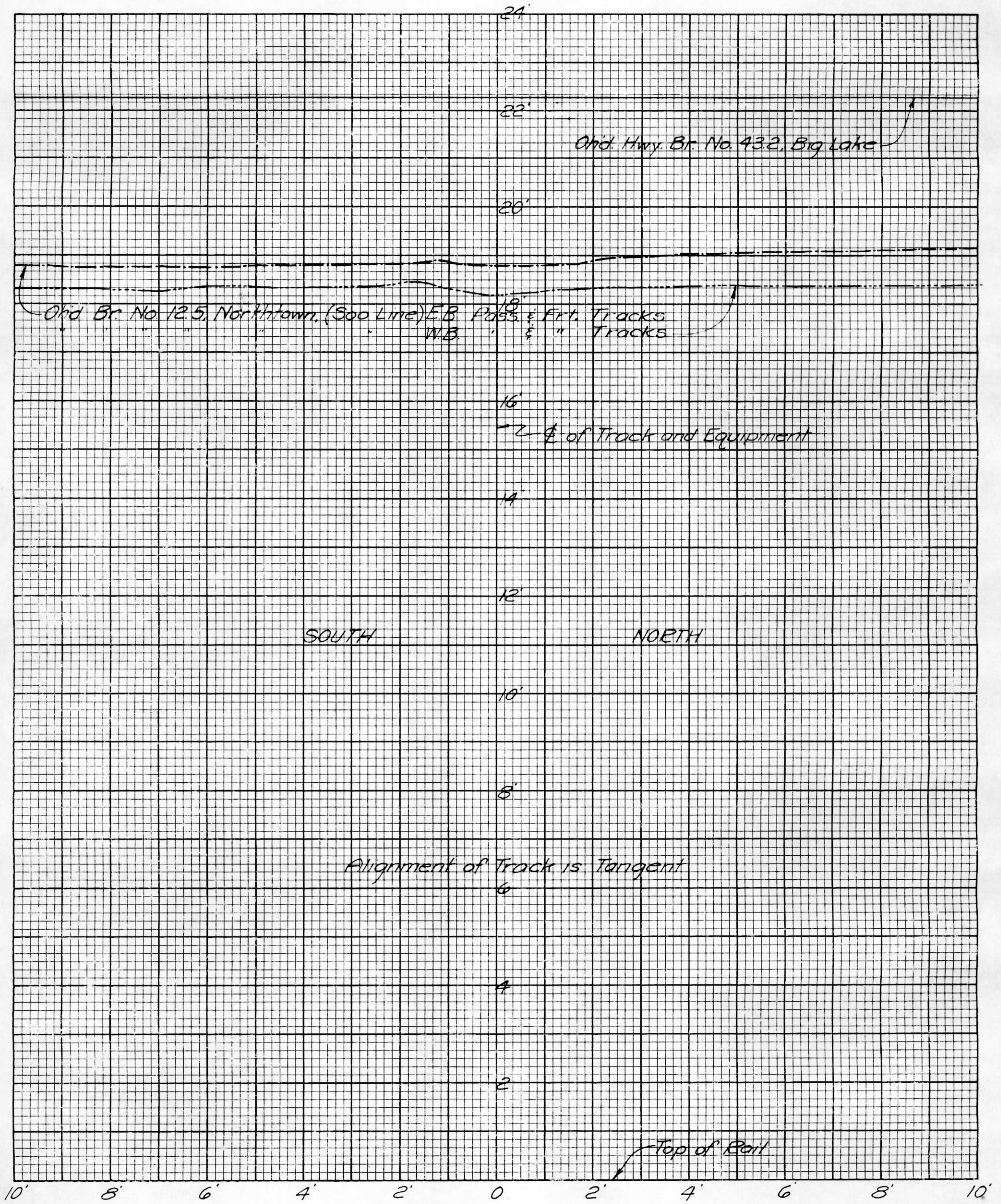

GREAT NORTHERN RAILWAY
MESABI DIVISION
**NORTHTOWN TO ST. CLOUD
CLEARANCE DIAGRAM**

OFFICE OF CHIEF ENGINEER, ST. PAUL, MINN.

CORRECTED TO

DATE PRINTED



167-5956-10

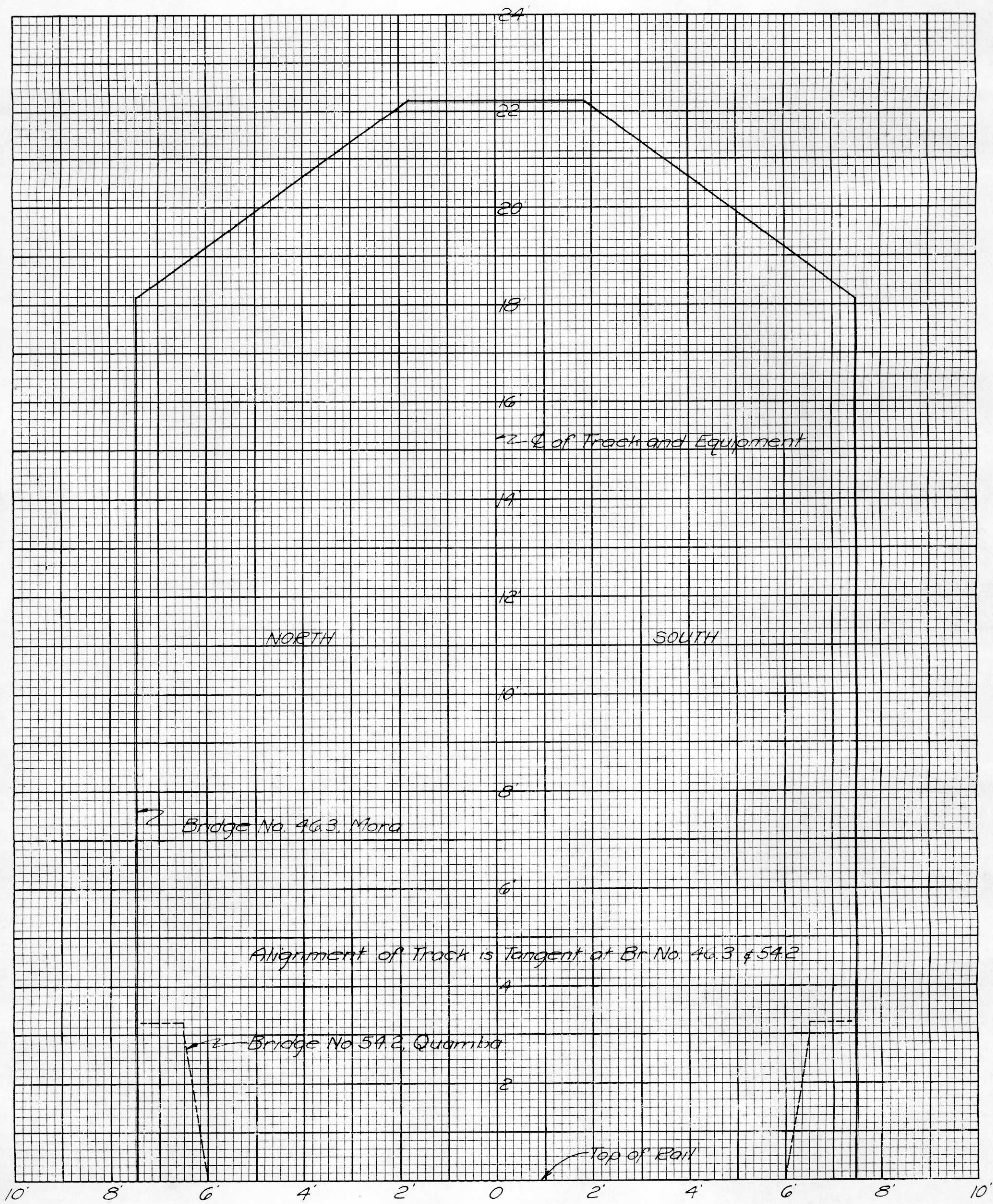

GREAT NORTHERN RAILWAY
MESABI DIVISION
**ST. CLOUD TO BROOK PARK
CLEARANCE DIAGRAM**

OFFICE OF CHIEF ENGINEER, ST. PAUL, MINN.

CORRECTED TO 5-11-1954

DATE PRINTED

167-5956-11

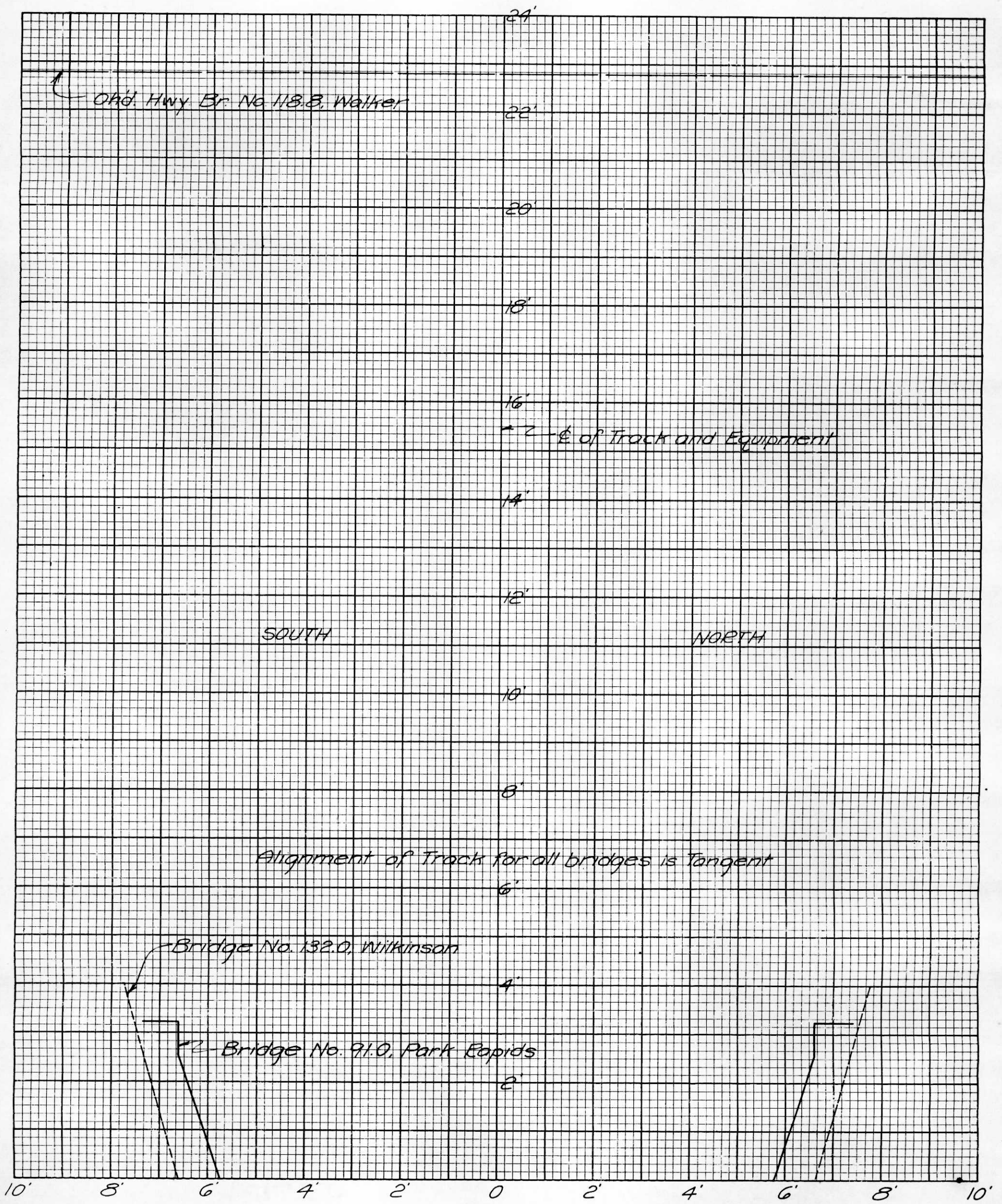

GREAT NORTHERN RAILWAY
MESABI DIVISION
**SAUK CENTRE TO CASS LAKE
CLEARANCE DIAGRAM**

OFFICE OF CHIEF ENGINEER, ST. PAUL, MINN.

CORRECTED TO July 1912

DATE PRINTED

167-5956-12

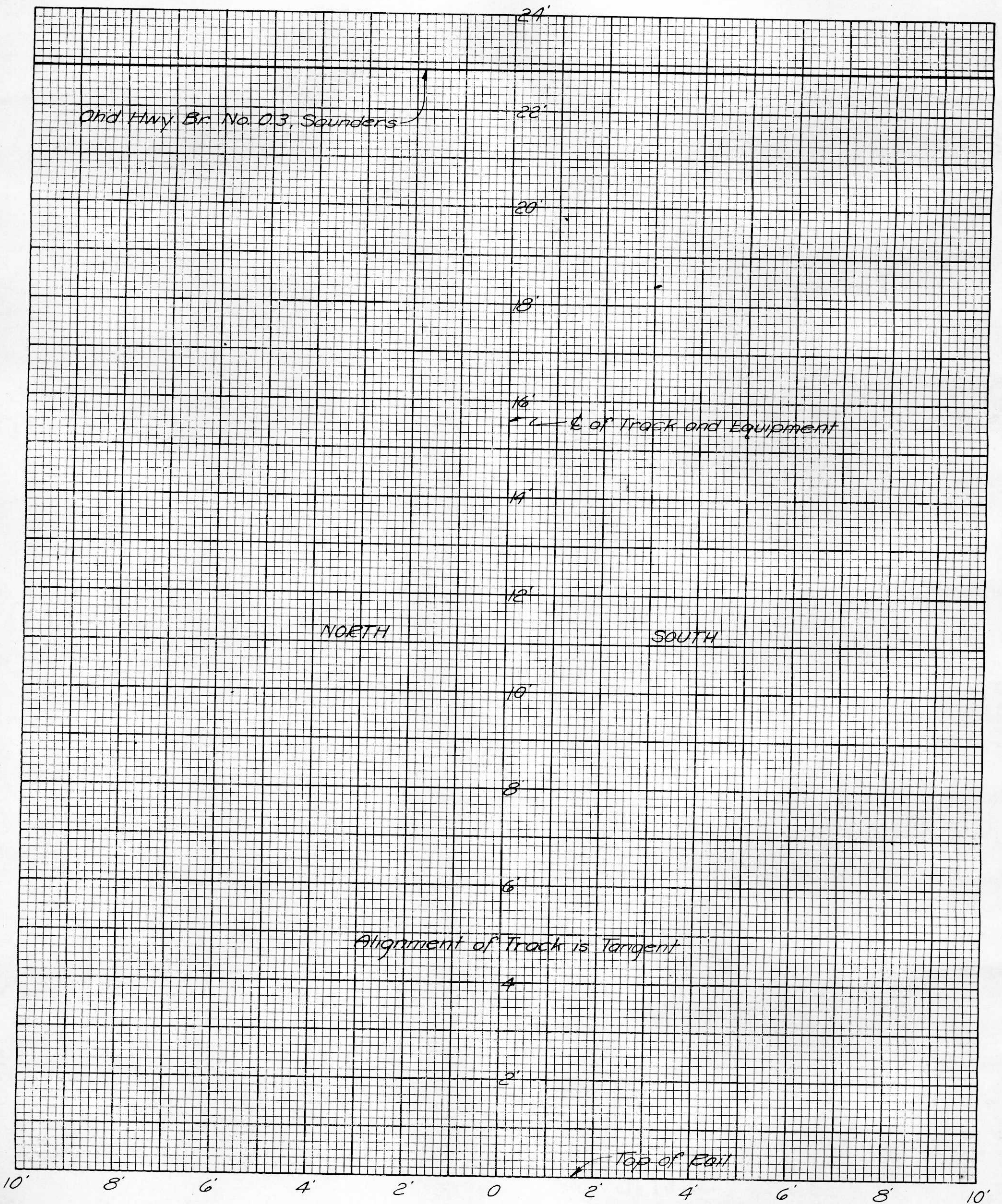

GREAT NORTHERN RAILWAY
 MESABI DIVISION
ALLOUEZ TO SAUNDERS
CLEARANCE DIAGRAM

OFFICE OF CHIEF ENGINEER, ST. PAUL, MINN.

CORRECTED TO 4/11/1955

DATE PRINTED

167-5956-13